

MUSEUM OF AMERICAN

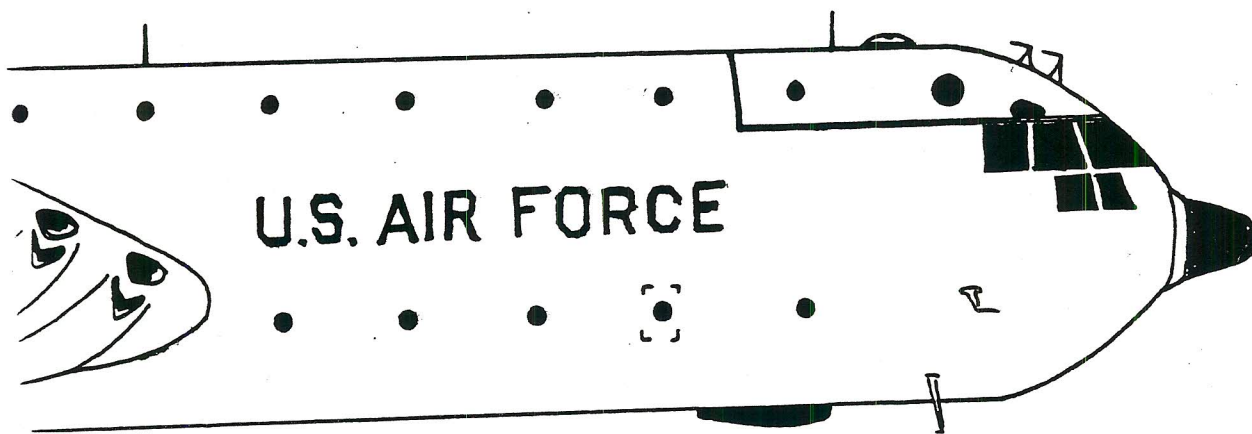

AVIATION

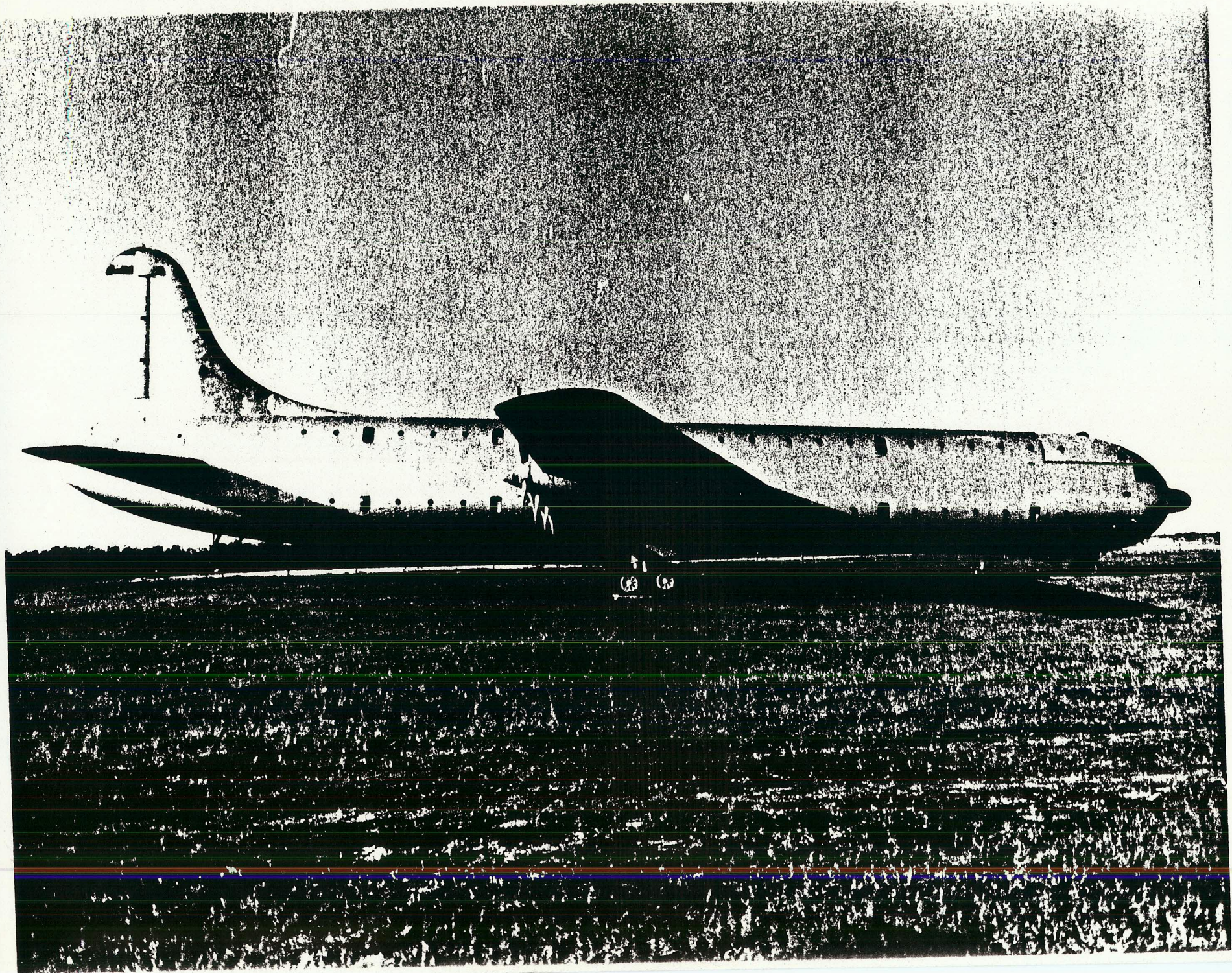



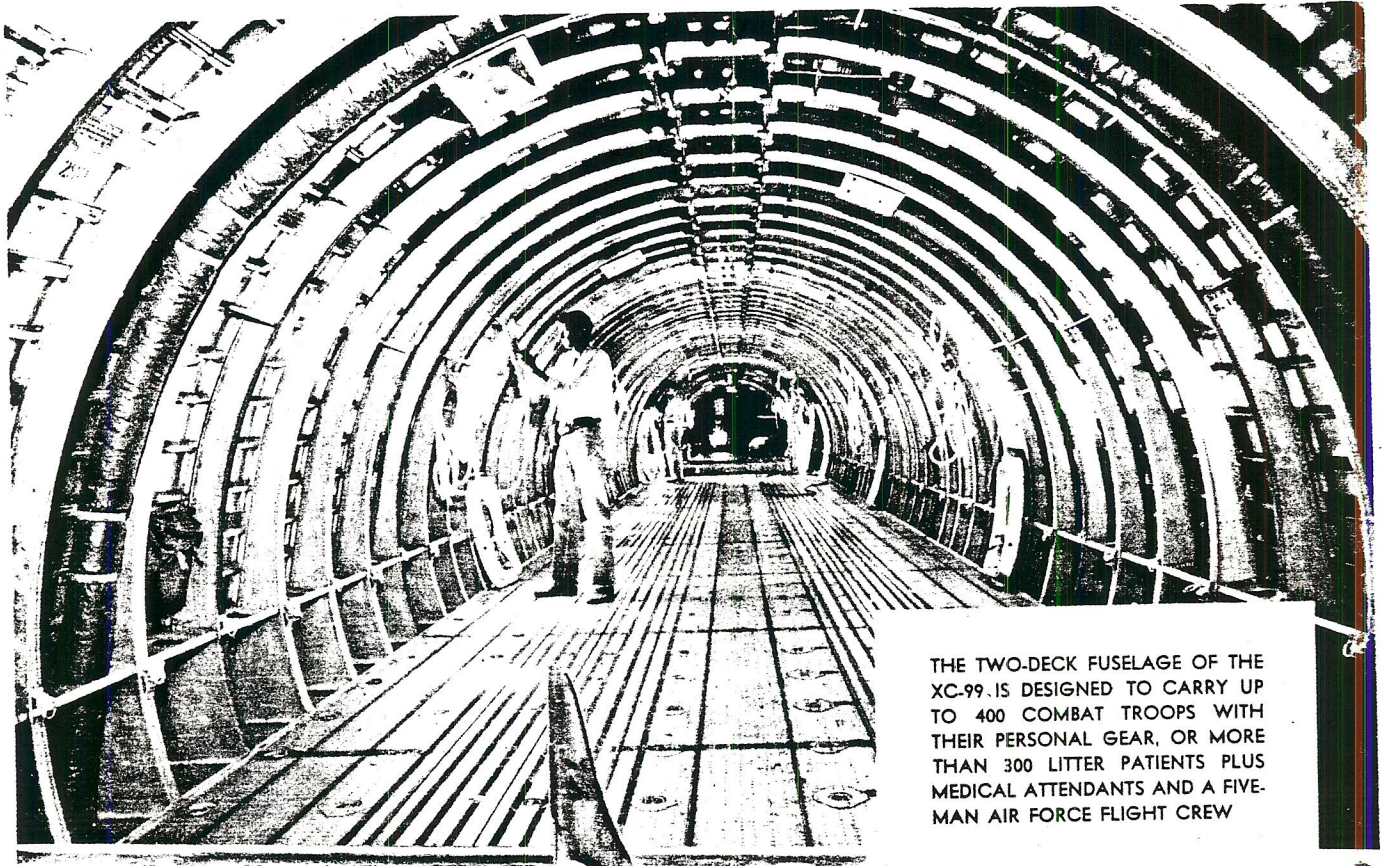

THE TWO-DECK FUSELAGE OF THE XC-99 IS DESIGNED TO CARRY UP TO 400 COMBAT TROOPS WITH THEIR PERSONAL GEAR, OR MORE THAN 300 LITTER PATIENTS PLUS MEDICAL ATTENDANTS AND A FIVE-MAN AIR FORCE FLIGHT CREW

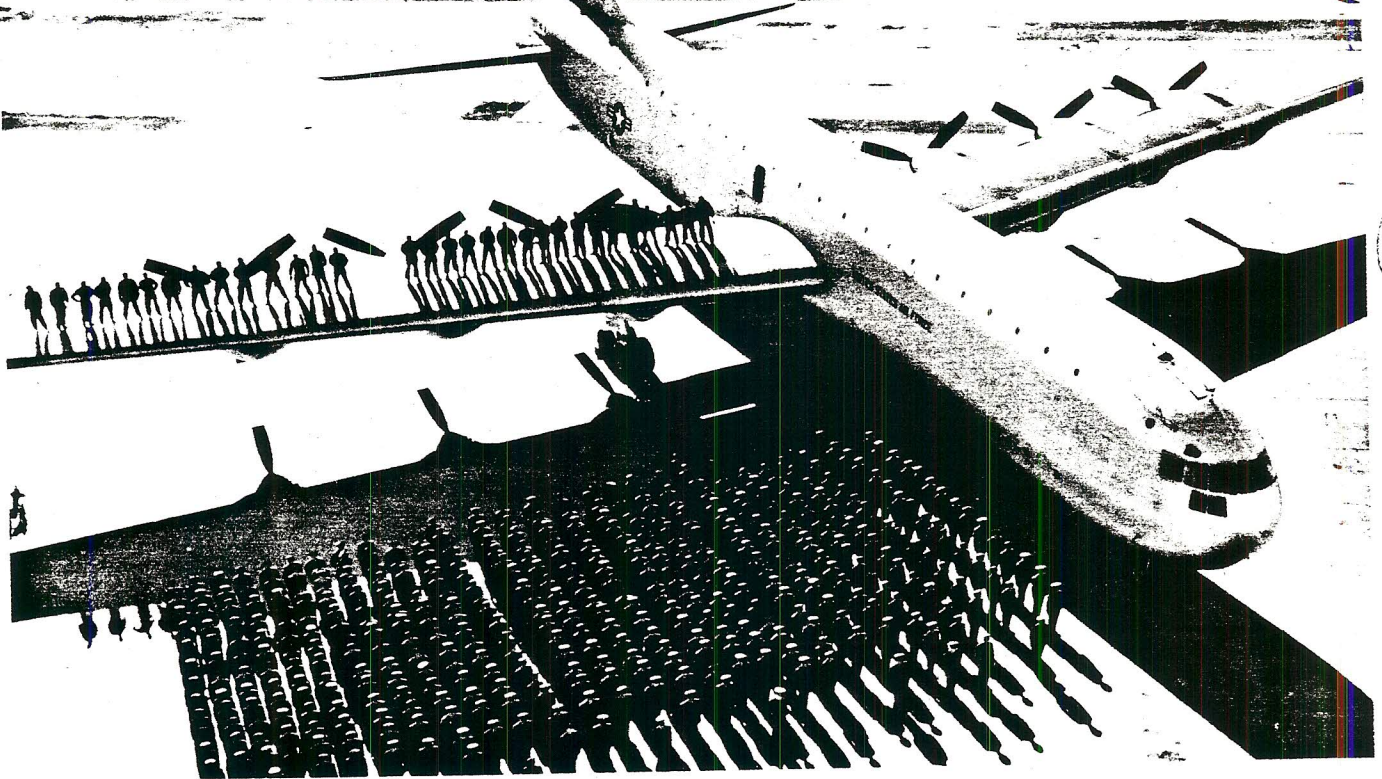

SAN
Antonio
Air
Depot
↓
SAMP

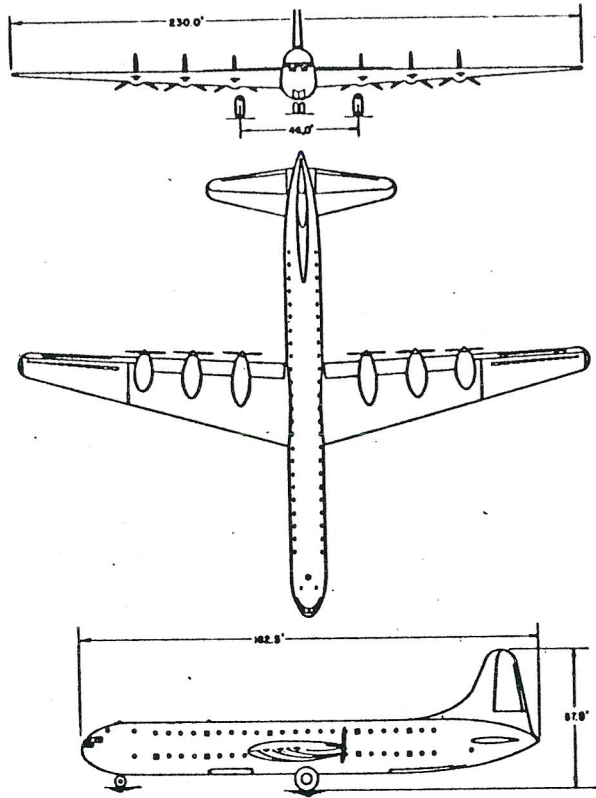

0' 15' 30' 45' 60'

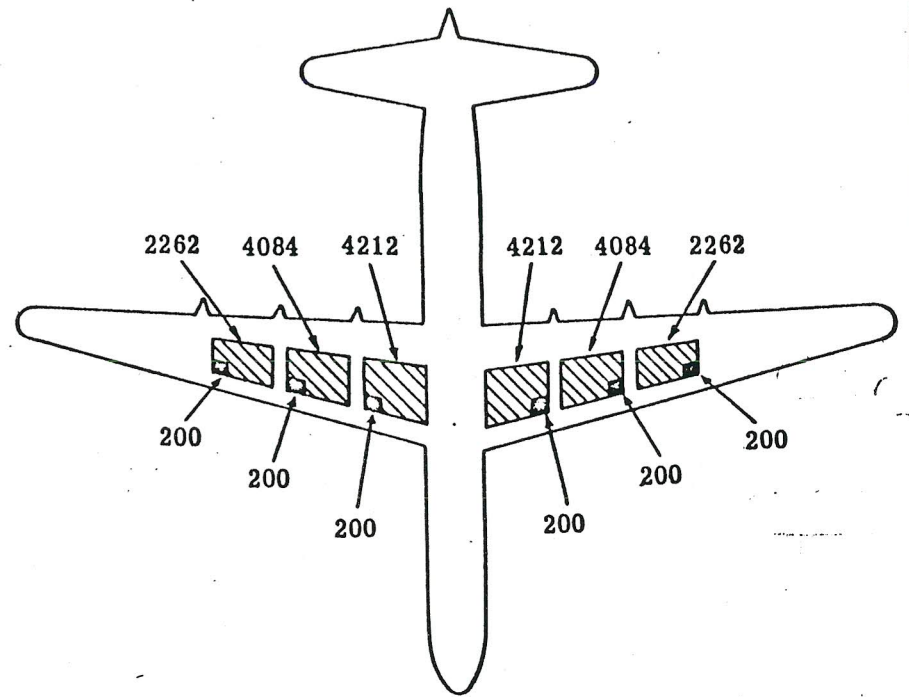

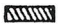
 Fuel

 Oil

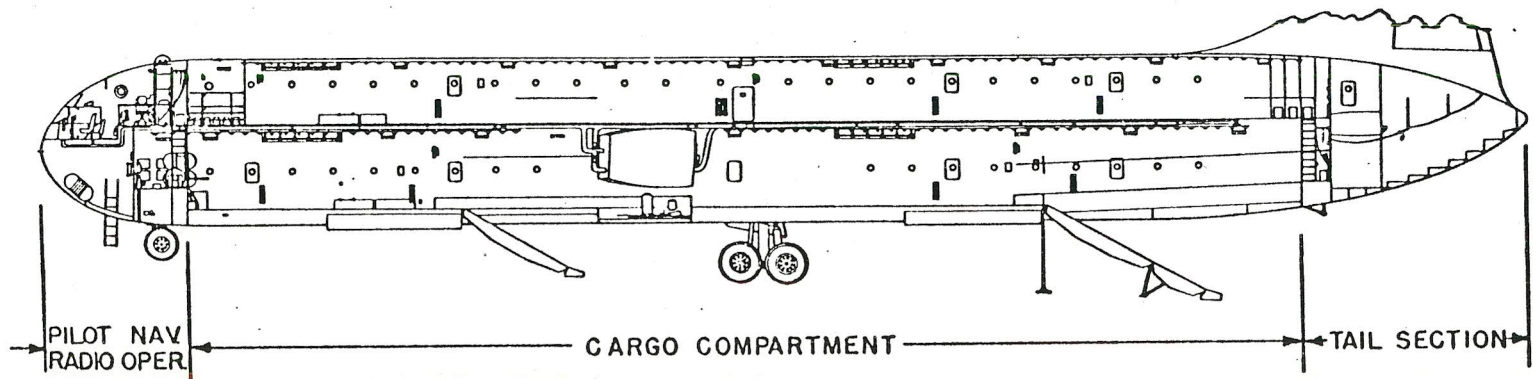

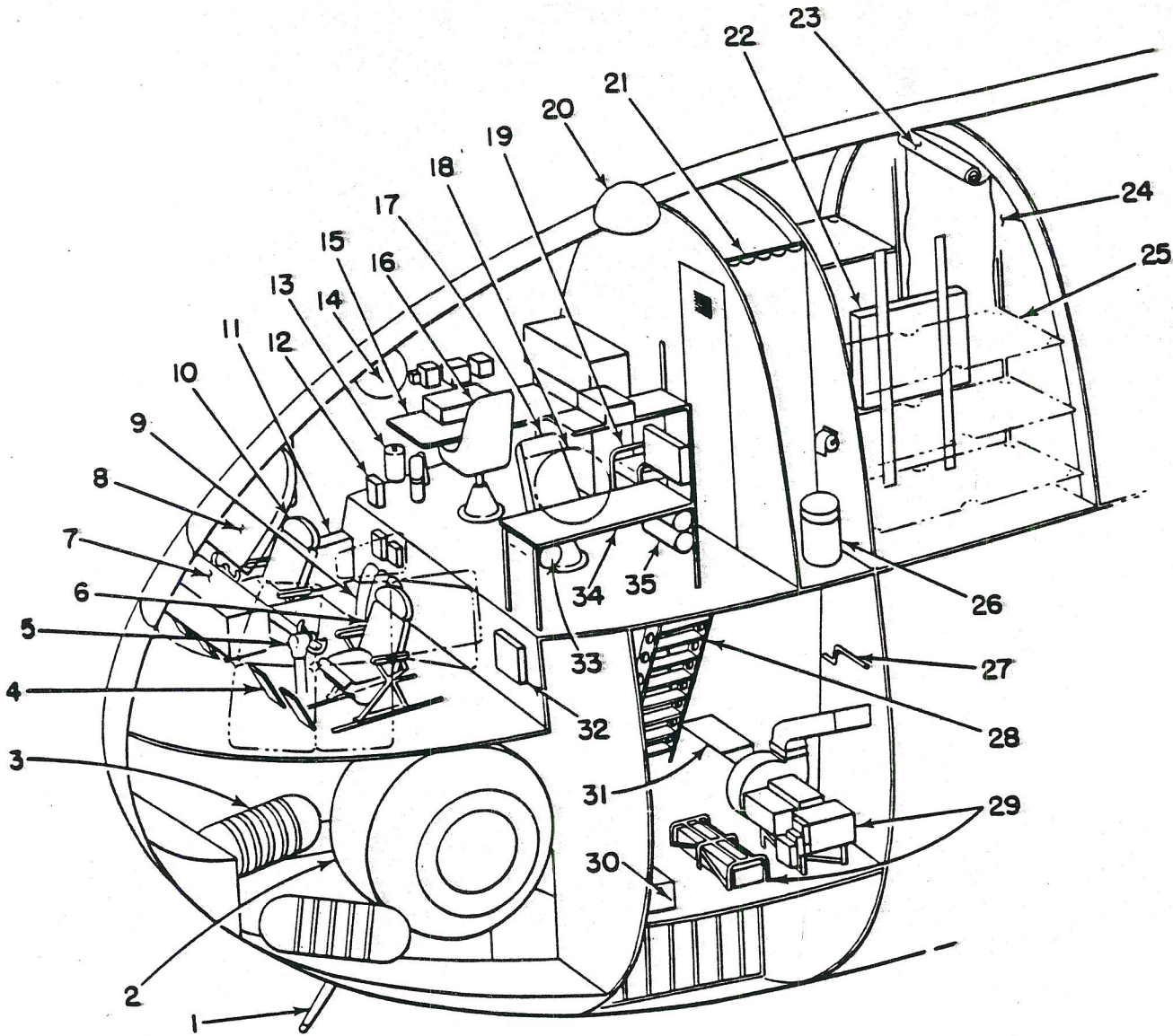

- | | |
|---|---|
| 1. Antenna (Ref) | 19. Astrodome Stand |
| 2. Nose Landing Gear Wheel (Ref) | 20. Astrodome |
| 3. Oxygen Cylinder (2) | 21. Curtain |
| 4. Pilot's Rudder Pedals (Ref) | 22. Flight Test Installation Junction Box (Ref) |
| 5. Control Column (Ref) | 23. Crew Quarters Curtain |
| 6. Pilot's Seat | 24. Curtained Bulkhead |
| 7. Flight Instrument Panel | 25. Crew Bunks |
| 8. Overhead Board | 26. Toilet Installation |
| 9. Flight Engineer's Seat | 27. Auxiliary Power Unit Crank |
| 10. Copilot's Seat | 28. Forward Stairway |
| 11. Flight Test Instrumentation (Ref) | 29. Auxiliary Power Unit and Control Box |
| 12. Emergency Hydraulic Fluid Can | 30. Battery Box (Ref) |
| 13. Emergency Hydraulic Reservoir (Ref) | 31. Radio Equipment Box (Ref) |
| 14. Radio Operator's Window (Ref) | 32. Data Case |
| 15. Radio Operator's Table | 33. Map Case |
| 16. Radio Operator's Seat | 34. Navigator's Table |
| 17. Navigator's Seat | 35. Drinking Water Tanks |
| 18. Navigator's Window (Ref) | |

Figure 1-2. Nose Section General Arrangement

RESTRICTED

XC 9.9

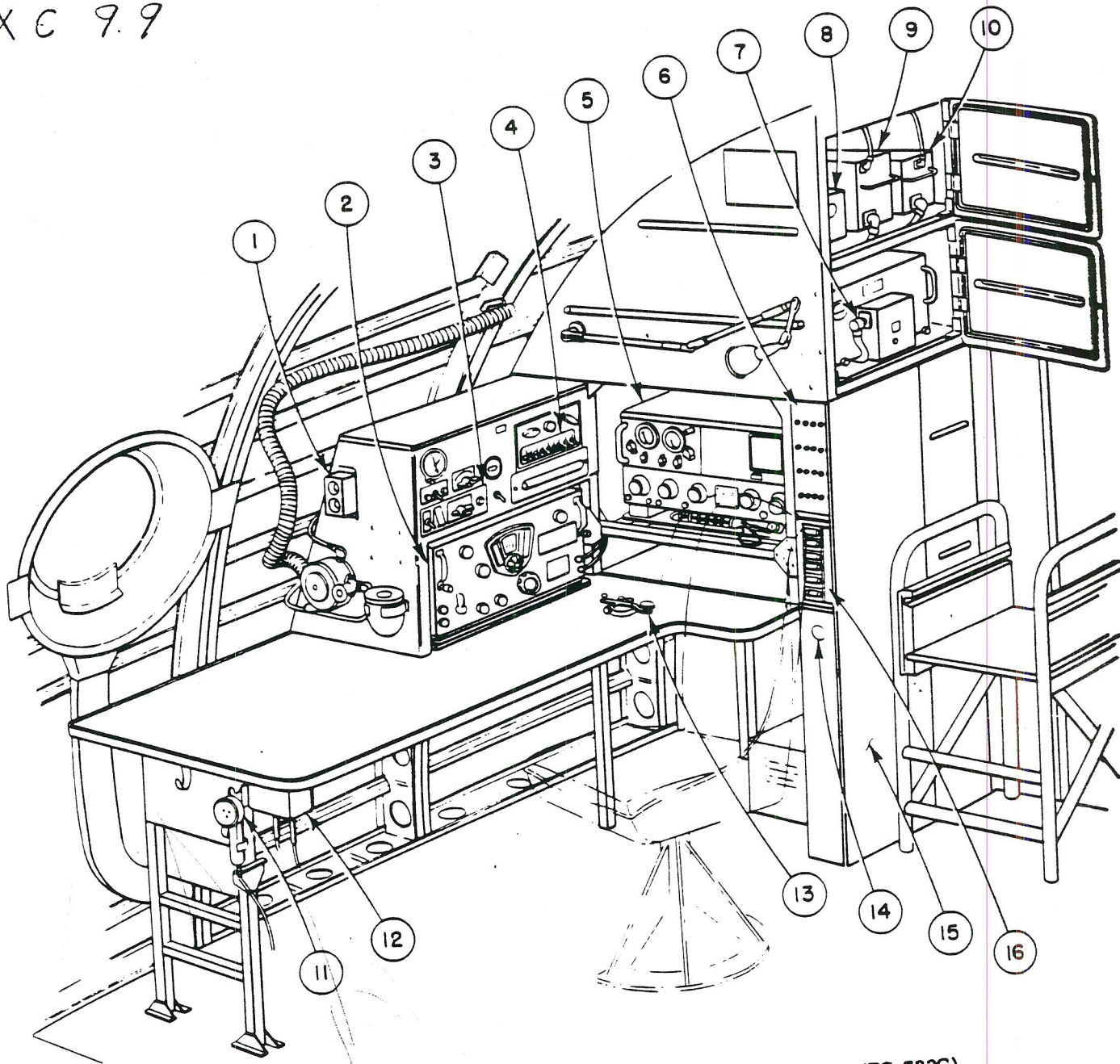

- 1. Destruction Switch (BC-765)
- 2. Receiver (BC-348)
- 3. Control Panel (SCR-695)
- 4. Interphone Control Panel (C-166/AIC-3)
- 5. Transmitter (T-47A/ART-13)
- 6. Communications and Navigation Equipment Circuit Breaker Panel
- 7. Transmitter-Receiver (RTA-1B)
- 8. Interphone Amplifier (AM-26/AIC)
- 9. Receiver (BC-733C)
- 10. Receiver (R-89/AFN-5A)
- 11. Microphone
- 12. Interphone Jack Box
- 13. LF Transmitter Key
- 14. Utility Power Receptacle
- 15. Radio Junction Box (J-89/ARA-10)
- 16. Radio Fuse Panel

Figure 5-4. (Sheet 1 of 2 Sheets) Radio Operator's Station

XC 99

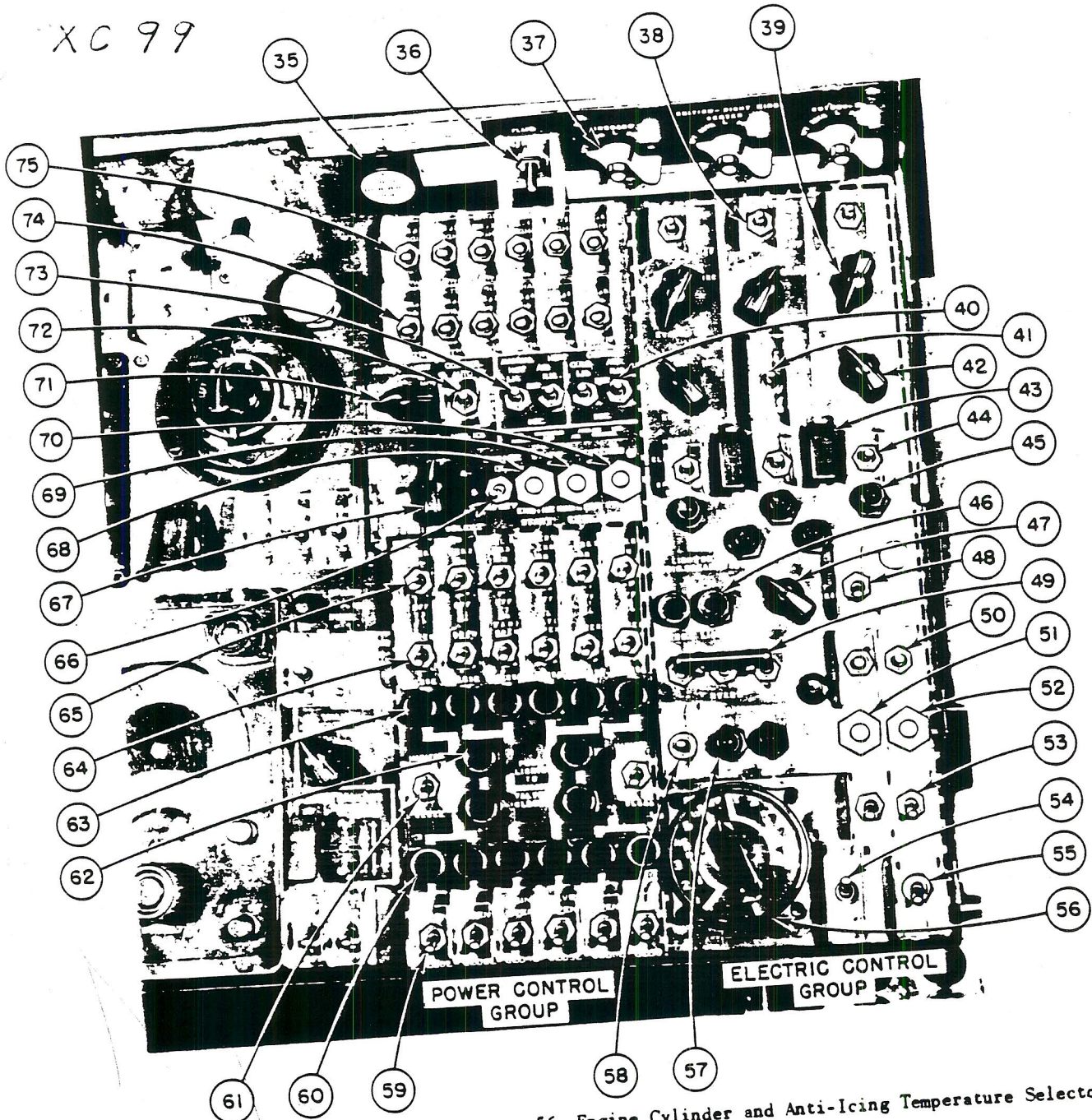

- 35. Propeller Reverse Pitch Switch
- 36. Flap Control Switch
- 37. Ignition Switches (Engines Nos. 4, 5, and 6)
- 38. Exciter Control Relay Switches (3)
- 39. Voltage Control Knobs (3)
- 40. Manual Cold-Air Switches (2)
- 41. APU Frequency Control Switch
- 42. Frequency Control Knobs (2)
- 43. Bus Tie-Breakers (2)
- 44. Alternator Breaker Switches (3)
- 45. Tie-Breaker Indicator Lights (5)
- 46. Synchronizer Lights (2)
- 47. Voltage and Frequency Selector Switch
- 48. External Power Supply Switch
- 49. Kilowatt and Kilovar Selector Switches (3)
- 50. APU Magneto Switches (2)
- 51. APU Starter Switch
- 52. APU Prime Switch
- 53. Converter Switches (2)
- 54. D-C Meter Selector Switch
- 55. Battery Switch
- 56. Engine Cylinder and Anti-Icing Temperature Selector Switch
- 57. Transformer Indicator Lights (2)
- 58. A-C Transformer Switch
- 59. Engine Valve Switches (6)
- 60. Engine Valve Indicator Lights (6)
- 61. Fuel Manifold Switches (2)
- 62. Fuel Manifold Indicator Lights (4)
- 63. Fuel Tank Valve Indicator Lights (6)
- 64. Fuel Tank Valve Switches (6)
- 65. Fuel Booster Pump Switches (6)
- 66. Engine Starting Safety Switch
- 67. Engine Starting Selector Switch
- 68. Engine Starting Switch
- 69. Ignition Booster Coil Switch
- 70. Engine Primer Switch
- 71. Flight Compartment Heat and Anti-Icing Control Rheostat
- 72. Automatic Heat Control Switch
- 73. Manual Heat Control Switches (2)
- 74. Turbosupercharger Switches (6)
- 75. Engine Fan Selector Switch (6)

Figure 1-5. (Sheet 2 of 2 Sheets) Flight Engineer's Control Pedestal

RESTRICTED

XC-99

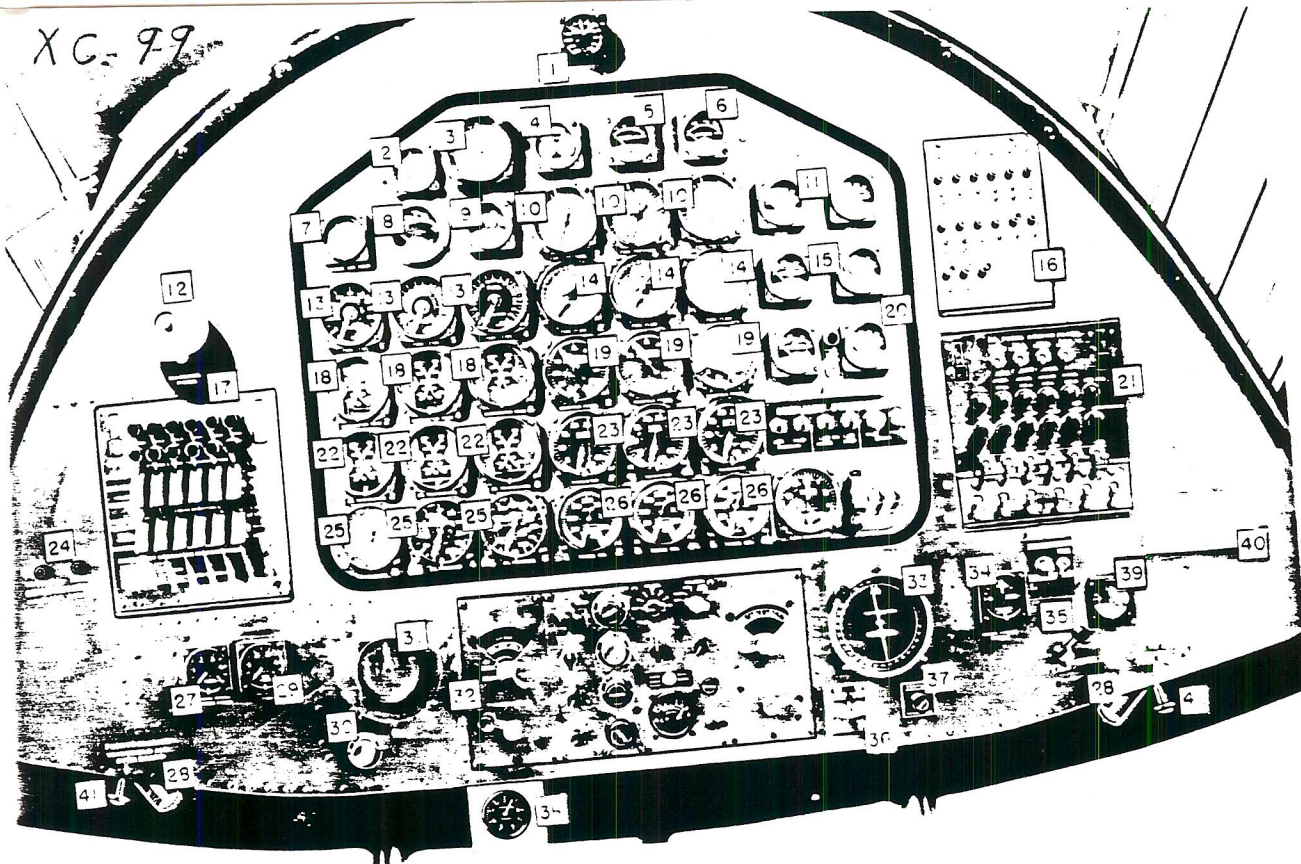

1. Flight Compartment Air Temperature Gage

2. Camera Counter

3. Clock

4. Phase Sequence Indicator

5. A-C Voltmeter

6. Frequency Meter

7. Outside Air Temperature Gage

8. Ammeter

9. D-C Voltmeter

10. Fuel Pressure Indicator (3)

11. Watt-Varmeter (2)

12. Warning Horn

13. Fuel Level Indicator (3)

14. Fuel Flow Indicator (3)

15. A-C Ammeter (2)

16. Instrument Circuit Breaker Panel

17. Fire Control Panel

18. Carburetor Air Temperature Indicator (3)

19. Manifold Pressure Indicator (3)

20. APU Control Panel

21. Heat Exchange Control Panel

22. Oil Temperature Indicator (3)

23. Engine Tachometer (3)

24. Control Locks Indicator Light (2)

25. Oil Pressure Indicator (3)

26. Torque Indicator (3)

27. Nose Wheel Steering Pressure Gage

28. Pilot's Fluorescent Light (2)

29. Main Hydraulic System Pressure Gage

30. L and R Indicator Sensitivity Control

31. L and R Indicator

32. Pilot's Radio Panel

33. Radio Compass

34. Brake Accumulator Hydraulic Pressure Gage

35. Manual Loop Control

36. Landing Light Switches

37. Radio Compass Indicator Light

38. Accelerometer

39. Dump Valve Control Switches

40. Windshield Duct Air Temperature Indicator

41. Windshield Dump Control Plunger

Figure 1-6. Overhead Board

RESTRICTED

Section I
XC 99

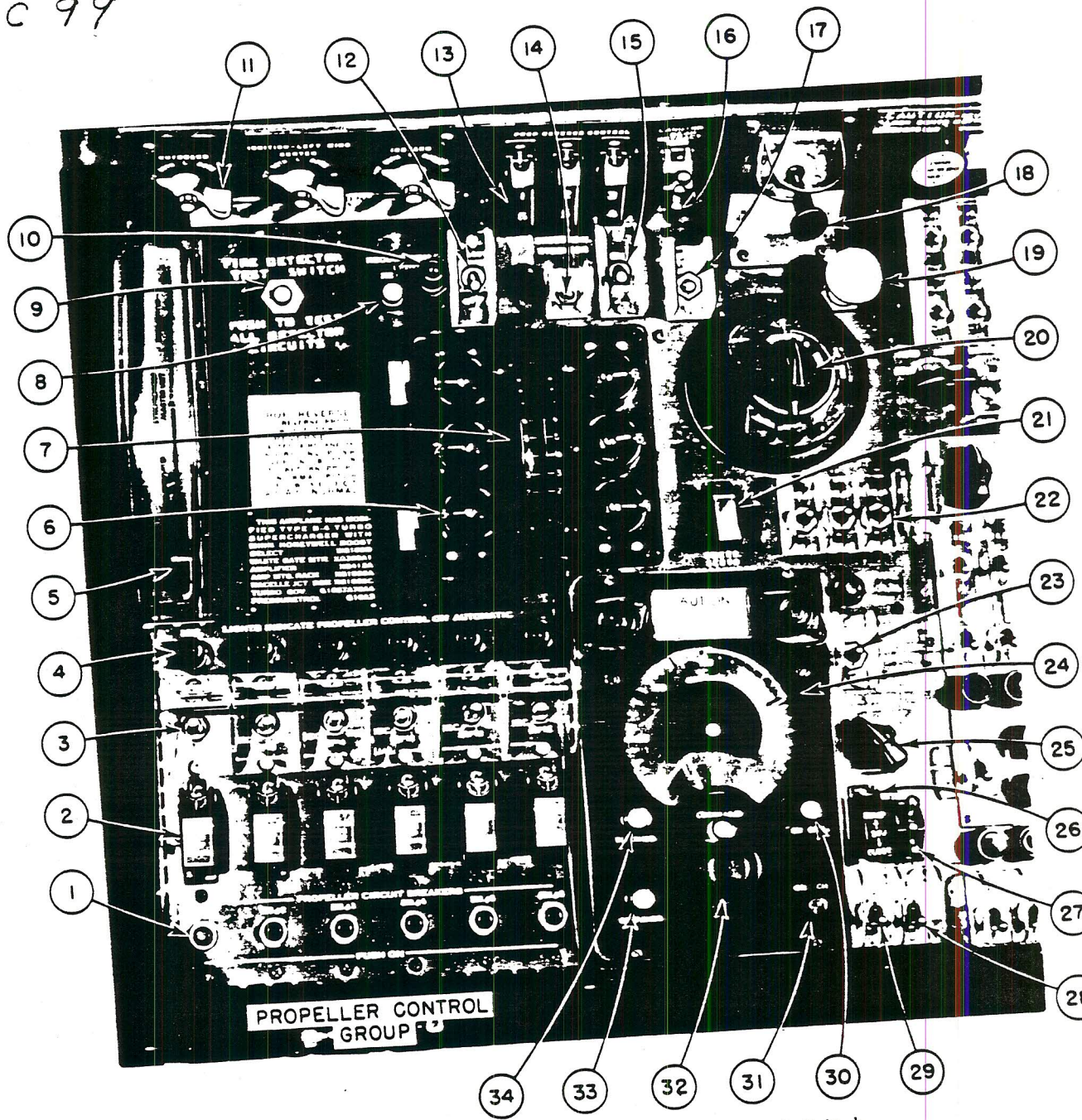

- 1. Propeller Circuit Breakers (6)
- 2. Propeller Feathering Control Switches (6)
- 3. Propeller Selector Switches (6)
- 4. Propeller Synchronizer Indicator Lights (6)
- 5. Master Motor Control Lever
- 6. Calibration Potentiometer Knobs (6)
- 7. Turbosupercharger Boost Selector Lever
- 8. Recognition Light Key
- 9. Fire Detector Test Switch
- 10. Recognition Light Flasher
- 11. Ignition Switches (Engines 1, 2, and 3)
- 12. Bailout Warning Switch
- 13. Propeller Reverse Selector Switches (3)
- 14. Nose Wheel Steering Control Switch
- 15. Master Motor Starting Switch
- 16. Landing Gear Control Switch
- 17. Autopilot Power Switch
- 18. Master Ignition Switch
- 19. Autopilot Clutch Switch
- 20. Autopilot Turn and Pitch Controller
- 21. Autopilot Emergency Servo Disconnect
- 22. Oil Dilute Switches (3)
- 23. Cargo Door Switch
- 24. Engine Cylinder and Anti-Icing Temperature I
- 25. Fuel Valve Indicator Light Test Switch
- 26. Water Ballast Dump Switch
- 27. Water Ballast Transfer Switch
- 28. Carburetor Air Filter Switch
- 29. Brake Pressure Emergency Override Switch
- 30. Engine Cylinder and Anti-Icing Temperature I
Switch
- 31. Check Switch
- 32. Balance Knob
- 33. Compensating Rheostat Knob
- 34. Slide Wire Rheostat Knob

Figure 1-5. (Sheet 1 of 2 Sheets) Flight Engineer's Control Pedestal

